



INSTRUCTION MANUAL

ELECTRIC COLUMN HEATER

MODEL NUMBER: COH40005

ITEM NUMBER: PSG-15RY

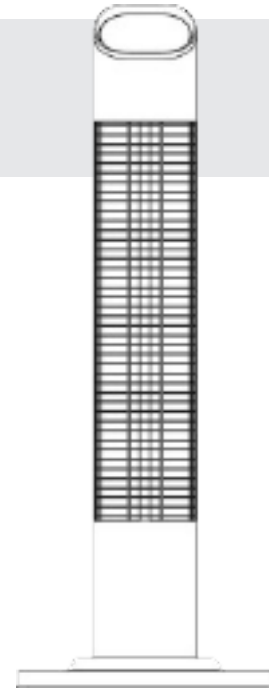

Thank you for purchasing your new
ELECTRIC COLUMN HEATER

DO NOT RETURN THIS ITEM TO THE STORE

Should you encounter problems after following all the steps herein contained please contact our Customer Support:
Call 1-888-227-3340 or email: customerservice@dekoliving.com. Kindly provide the model number, place and date of purchase and a short description of the problem.

LIMITED WARRANTY This product has a 1 year Limited Warranty. This warranty is limited to the replacement of defective parts only. Labor charges and/or damage incurred during installation, repair, replacement as well as incidental and consequential damages connected with the above are excluded. Any damage to this product as a result of neglect, misuse, accident, improper installation or use other than the purpose **SHALL VOID THIS WARRANTY**



IMPORTANT, RETAIN FOR FUTURE REFERENCE: READ CAREFULLY



Please read and understand this entire manual before attempting to assemble, operate or install the product. Failure to follow the dangers, warnings and cautions contained in this owners manual may result in a fire or explosion causing damage to property, serious bodily injury or death

08/2024



WARNING

FOR YOUR SAFETY

For Indoor Use Only

(inside any enclosure)

Installer: Leave these instructions with the consumer.

Consumer: Keep these instructions for future reference.

1) Improper installation, adjustment, alteration, service or maintenance can cause injury or property damage.

2) Read the installation, operation, and maintenance instructions thoroughly before installing or servicing this equipment.

3) Failure to follow these instructions could result in fire or explosion, which could cause property damage, personal injury or death.

1. Read all instructions before using this unit.
2. **DO NOT** leave this unit unattended when in use.
3. This heater will get hot when in use. Do not touch hot surfaces.
4. **Caution:** Some parts of this product can become very hot and cause burns. Particular attention has to be given when children and vulnerable people are present.
5. **DO NOT** move the unit when in use. Wait until the heater is completely cool before moving and check that it has been unplugged from the power supply.
6. Position the unit at least 1m away from highly combustible materials such as furniture, trees, leaves, dry grass and bushes.
7. The heater must be a minimum of 1.8m away from the ground and a minimum of 0.5m away from the ceiling of a building or overhanging items.
8. The heater must not face with the heating element pointing upwards towards a ceiling. The heater element must be facing the area it is to heat.
9. **WARNING:** In order to avoid overheating do not cover the heater. It is not for drying clothes.
10. Keep children and pets at a safe distance from the unit.
11. This appliance can be used by children aged from 8 years and above and persons with reduced physical, sensory or mental capabilities or lack of experience and knowledge if they have been given supervision or instruction concerning use of the appliance in a safe way and understand the hazards involved.
12. Children shall not play with the appliance. Cleaning and user maintenance shall not be made by children without supervision.
13. **DO NOT** operate the heater if any signs of damage or malfunction manifest themselves.
14. **DO NOT** attempt to repair or adjust any electrical or mechanical functions on this unit. The unit does not contain any user serviceable parts. Only a qualified electrician should perform servicing or repairs. Attempting to repair the unit yourself will void your warranty.
15. If the power cable is damaged, it must be replaced by the manufacturer, its service agent or similarly qualified persons in order to avoid a hazard.
16. **DO NOT** handle the element with bare hands. If it is inadvertently touched, remove finger marks with a soft cloth and methylated spirits or alcohol, otherwise the marks will burn into the element causing premature heater failure.
17. **DO NOT** replace or attempt to replace the element in this product.
18. This product is suitable for indoor and outdoor use. Do not use this heater in the immediate surroundings of a bath, shower or swimming pool.
19. This product must not be left outdoors exposed to the elements for long periods of time.
20. **DO NOT** touch the plug with wet or damp hands.
21. **DO NOT** run the power cable under carpeting.
22. **DO NOT** cover the power cable with rugs, runner, or similar coverings. Arrange the power cable away from foot traffic and where it will not be tripped over.
23. **DO NOT** wind the power cable around the unit.
24. **DO NOT** insert or allow foreign objects to enter any ventilation or opening on the heater, as this may result in electric shock, fire, or damage to the heater.
25. To prevent a possible fire, do not block the air vents.
26. A heater has hot and arcing or sparking parts inside. Do not use in areas where petrol, paint, explosive and/or flammable liquids are used or stored. Keep unit away from heated surfaces and open flames.
27. Where possible, avoid the use of an extension cable as this may overheat and cause a fire. However, if you have to use an extension cable, ensure it is suitable for the purpose, has been tested for outdoor use and preferably has an RCD device fitted or attached.
28. Always ensure the heater is plugged into a suitable socket, one that is tested for outdoor use.
29. To disconnect heater, turn controls to OFF, then remove plug from socket. Do not unplug by pulling on the power cable.
30. Always unplug the unit and ensure the unit is completely cold before moving, cleaning or storing.
31. This heater is intended for domestic use only and should not be used commercially for contract purposes. Any alternative use, not recommended by the manufacturer, may result in fire, electric shock, or injury to persons.
32. The use of attachments on the heater is not recommended.
33. **WARNING:** This heater is not equipped with a device to control the room temperature. Do not use this heater in small rooms when occupied by persons not capable of leaving a room on their own, unless constant supervision is provided.
34. Check exterior walls for areas of damage before installing the heater.
35. Always use on a dry, suitably strong, stable, flat and level surface.
36. Check exterior walls for communication and electrical cables and pipelines. Should any service lines be present in the immediate vicinity do not install your heater, find an alternative location to install this product.
37. **DO NOT** position directly above or below an electrical socket.
38. **DO NOT** remove any of the warning stickers or signs from the product.

ALL ABOVE MUST BE EXACTLY FOLLOWED.

Installation for Wall Mounting

Before installation, please pay attention to below notes

- Products should be put down gently.
- Acid and alkali environment installation is not recommended.
- The product must be grounded.
- The product was required to check the product brand mark on the voltage and the local voltage whether conform.
- Ensure the power rating should have sufficient current carrying capacity.

1. Pass the power cord through the hole in the middle of the chassis (as shown below).
(shown in figure 1)

Figure 1

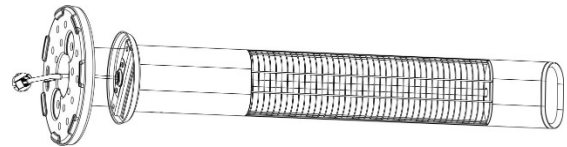

2. Fasten the chassis to the heater with two flat pads and screws, and then fix the power cord to the chassis with two screws and plates (as shown below).
(shown in figure 2)

Figure 2

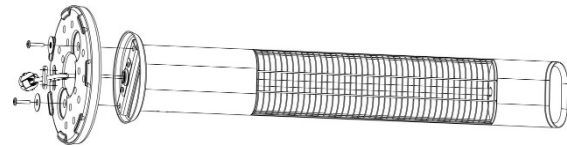

Bracket Installation

1. Take the bracket piece from the accessory package, place it vertically into the product's back panel slot, and rotate it counterclockwise into the left and right grooves. (1)
2. Push the bracket piece all the way up. (2)
3. Position the bracket ring upwards and secure it with 2 M4*12 screws. (3)

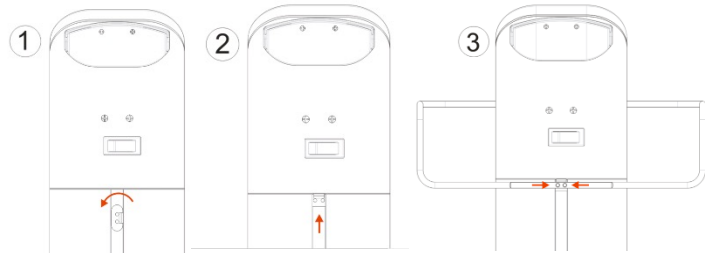

Operating Instructions

The heater must provide appropriate voltage and frequency (AC120V,50Hz) and be connected to separate, properly grounded branch circuits protected by circuit breakers that comply with wiring rules. the operating position only when the heater is in upright condition.

Switch Instructions

1. Press the product to turn on the key blue indicator light up, the display screen does not show
2. Touch on key press 1, blue indicator unchanged, show P0, product does not work
3. Touch the key to press 2, the blue indicator turns red, showing F1, product starts working.
4. And so on. A total of nine, that is, touch key press 10, indicator red, display F9.
5. Touch the key to press 11, the indicator turns blue, display P0.

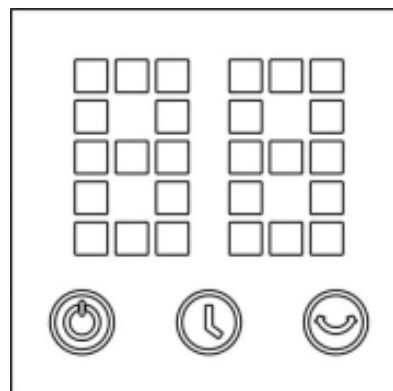

Timing Instructions

1. Touch timing key press 1, blue indicator unchanged, display 00
2. Touch the timing press 2, the blue indicator turns red, display 01
3. Touch timing button press 3, indicator red, display 02
4. And so on, the timing is 24 hours.
5. Touch the shake button, shake the head function on, the product begins to rotate.

Shake Head Instructions

1. Touch the shake button, shake the head function on, the product begins to rotate.

Remote Control

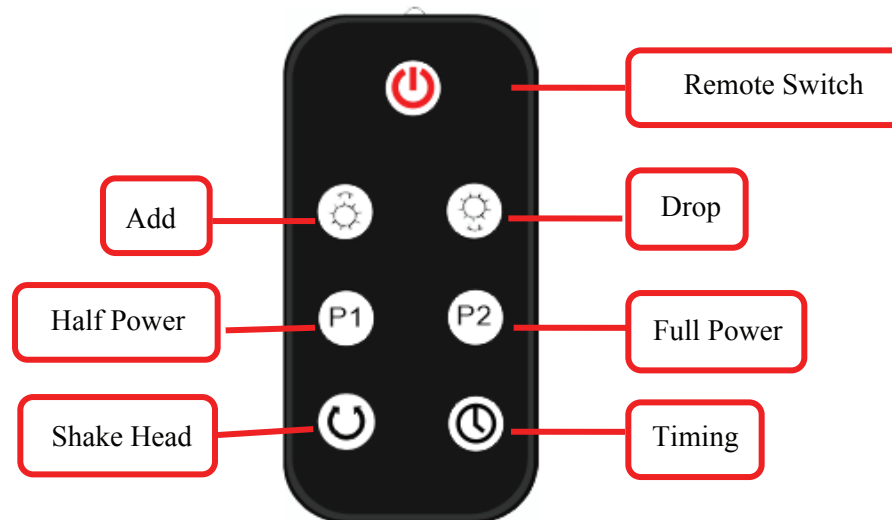

1. Press remote control key, display P0 screen
2. Press add key 1, that is, the first, touch screen key blue indicator light red, display F1, that is, 10% of the total power.
3. Click add key 2, that is, second, touch screen key indicator red, display F2, that is, 20% of the total power.
4. And so on. Total 9
5. Press the "P1" button for half the total power. Display P1
6. Press the "P2" button for full power. Display p2
7. Press shake head key, shake head function open, the product begins to rotate.

Instructions for Connecting to WIFI

1. Download and install the Tuya Smart APP on your mobile phone, and register.
2. After successful registration, enter the APP.
3. Power on the device (heater) and wait for the network indicator light to flash blue. Then, click "Add Device" in the APP.
4. Enable Bluetooth and WiFi. The APP will automatically discover the device. If it doesn't, you can try adding it manually.
5. Enter the WiFi password, click "Confirm," and patiently wait for the success screen to appear, then click "Finish."

Manual addition method:

1. Select Manual Add → Small Appliances → Heater → Enter router name and password to connect.

Network Configuration Instructions:

1. Network Setup: Automatically enters SMART CONFIG mode upon initial power on.
2. Reset/Enter Network Mode: Touch network setup operation: In the powered-off state, long press the timer button for more than 5 seconds to switch to network mode.

Maintenance

Attention! Careful and regular maintenance of **Infrared Heater** is required to maintain a long and efficient operation of your appliance.

- Check the cleanliness of the Reflector and IR-Filament at least once a month. If necessary, apply cleaning and maintenance instructions.
- The number of checks may be increased considering the amount of the dust in the environment.
- Check the shape of the heater, inner wire and appearance while cleaning the appliance. If any problem with heater please contact professionals.
- Check the cable and plug while cleaning the heater. If any problem with heater please contact professionals.
- It is recommended to replace the mirror every two years to improve the operating efficiency.

Cleaning

Attention! Regular and careful cleaning helps your **Infrared Heater** operate for longer years and more efficiently.

- For your safety, make sure the power is off before cleaning your appliance.
- Use a slotted screwdriver to remove the front grille from the frame's entrance.
- For your safety, make sure the power is off and the power cable plug must be unplugged.
- Reflectors and filaments must be cleaned with soft cloth, smooth brush. Cleaner should not too wet and could moist, the cleaner should not contain any chemicals.
- Avoid using cleaning tools (cleaners, etc.) that can damage reflectors.
- Insert a wire grid with a slotted screwdriver.

Specifications

Voltage: AC 120V

Frequency: 60Hz

Electric Power: 1500W



The symbol below
is on the product or in the instruction manual.



This means that your electrical or electronic
equipment should be disposed at the end of its life
separately from your household waste.

There are separate collection systems
for recycling in the your local area.

For more information,
please contact the local authority or
your retailer where you purchased the product.